

THE HOOSIER PACKET - JULY 2015

NELSON ADOLPH McCLURE **And His Wabash & Erie Canal Connections** By Charles Davis

Nelson Adolph McClure was born July 14, 1813 in Botetourt county, Virginia to Richard Renshaw and Mary F. 'Molly' Crawford McClure. His father was a Lieutenant in the Continental Corps. Nelson's mother died in 1814 in the above county. His father, who had been born in Lawrence county, Kentucky, moved his family back there.

At the consent of his sister, Nelson became part of the household of his brother Mordecai, who emigrated to Indiana in 1826. On May 9 of that year they reached their journey's end west of Annapolis, Parke county, Indiana, stopping for the night with Conrad Tenbrook on the farm owned later by Andrew Tenbrook in the SW ¼ of Section 10. Without delay arrangements were made and they became residents of the Cornelius Blue farm, three miles west of town, near the future Foundry Hollow that was started in 1834 by Wm. G. Coffin.

At the age of 13 Nelson began clearing off the forest that was on the farm so that more land could be cultivated. He recalled riding behind John Newlin Carter on a horse as a lad and following an Indian Trail to the Isaiah Mote Grist Mill that was located north of the now extinct town of Cincinnati, Indiana. The mill was built on Roaring Creek. Deed Record 4/59. This was one of the mills not recorded in Parke county histories.

Nelson was married in Parke county on January 30, 1838 to Elizabeth Miller. At about this time Nelson went to work for William Garten Coffin at the old Iron Foundry in Foundry Hollow. At this place he and his family moved into a one-room log cabin where two of their ten children were born, Sara Louise and Charity Ann McClure.

Coffin's company was made up of the foundry, a steam saw mill, finishing shop, and blacksmith shop. It also had a pork house and flatboat yard located on 2 acres on Sugar Creek.

The Wabash & Erie Canal started construction through Parke county in 1844. The Sugar Creek Feeder Dam for the canal was built at the mouth of Coke Oven Hollow. Nelson used a steam powered saw mill for cutting timber for the Feeder Dam.

At the time the canal was being dug, John Tenbrook Campbell lived with his uncle Josiah Campbell.

Josiah had a farm where the feeder dam was built. John worked on the canal. (See John Tenbrook Campbell and His Wabash & Erie Canal Connections, Hoosier Packet, August 2014 by Charles Davis) John recalled, "My uncle Josiah boarded 20 to 30 choppers and teamsters. They were all 'Hoosiers' and 'Suckers.' The teams were two to three yoke of oxen. No horses were used in the log and timber hauling. The hauler went up the ridges north of the Creek and came back with long round logs full length of the trees and also hewed timber for the feeder dam across Sugar Creek. They dragged their loads close by our door yard. The cracking of the oxen whips and swearing at the oxen sounded like skirmish firing at the opening of a battle. Captain John Lindsay, from the Indiana Iron Furnace five miles southwest of Clinton, was boss of the choppers and teamsters. He was the greatest expert with an ox whip I ever saw. I thought then that if I could ever be as great a man as John Lindsey, I would never seek any greater honors. He had a heavy, rich voice and was a great SINGER. He was a captain in the 14th Indiana Infantry during the Civil War." Capt. Lindsey is buried southwest of Universal in Dolton Cemetery.

In 1846 Nelson McClure joined the Methodist Episcopal Church and remained in it the rest of his life, a period of 62 years. The church was built in Annapolis in 1850 on lot 5, block 1, at the SE corner of Apple and Washington streets. Before his death he claimed to be the last resident member of those constituting the church at the time of the building of the house. It closed its doors and sat empty before 1939.

In 1851 Nelson left Foundry Hollow and moved to lot 2 block 5 in Annapolis. The 1851 Tax List gives the lot's value of \$140. There Nelson took up the occupation of a house painter. His grandchildren Fred and Ella said that he painted most of the houses in the town. He is described as being a tall man with red hair. The Rockville circuit clerk's office records state he was Penn township's Constable as of April 13, 1859.

During the Civil War there was a lot of excitement in Parke county. There were several occurrences between Unionist and Confederates or "Copperheads," which called themselves Knights of the Golden Circle. Nelson "McClure's War" grew up out of a quarrel between some of the Confederates. Sheriff Geo. B. Inge arrested Hiram Phipps on a charge of harboring deserters. At Indianapolis Phipps was acquitted and was mad about it. Bill Hamilton swore out a writ for Ira Phipps for stealing a hog. The writ was placed in the hands of Constable McClure, who summoned George Bradford, Jacob Taylor, William Carty, and

THE HOOSIER PACKET - JULY 2015

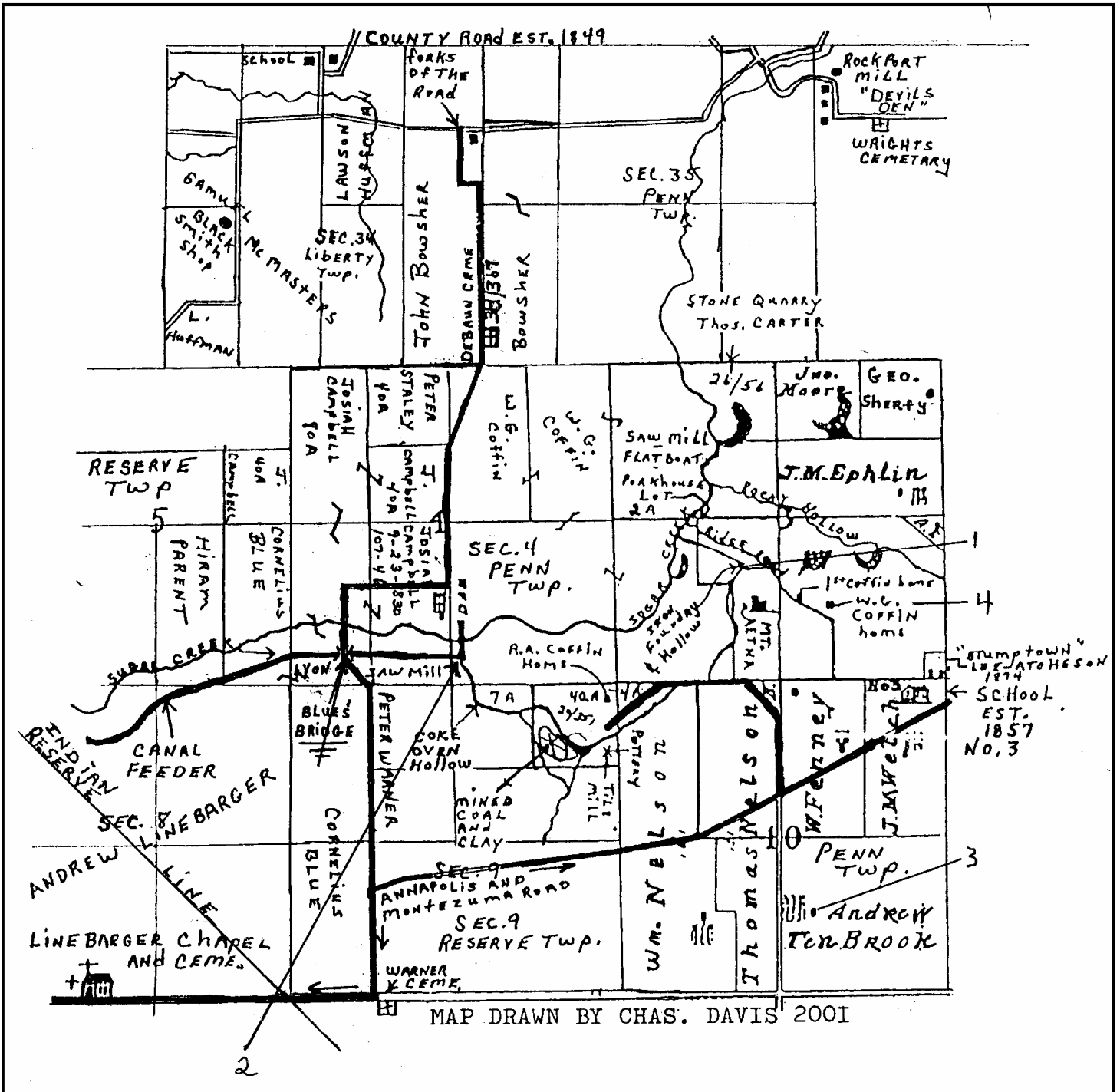

A PORTION OF PARKE COUNTY, INDIANA

1. Iron Foundry in Foundry Hollow near where Nelson A. McClure lived for awhile
2. Sugar Creek Feeder Dam that backed up water to be fed to the mainline Wabash & Erie Canal
3. May 9, 1826, Tenbrook Farm where Mordicai stopped
4. Wm. G. Coffin home

THE HOOSIER PACKET - JULY 2015

an old canal man, William Linder McIntire, as a posse. They armed themselves with 15 short Henry repeaters, got on their horses and rode up to Sugar Creek township where many “Copperheads” lived.

Ira and Hiram Phipps were found at Bennage Mill on Green Creek with some others inside the mill. McClure said he had a writ for Ira. One woman ran out the back door and went up the hill at a ‘42 gait’ screaming like a panther. McIntire said his hair stood up so that he had to reach up to feel his hat! He looked into a window and saw two men in the middle of the room with guns and another in the corner. One of them said, “open this door and I will kill every d—d one of them.”

Phipps stepped into the door with a double barreled shotgun. As McIntire squatted down, Phipps fired both barrels barely missing him. The fugitives ran out the back door, up the hill and fired shots at the posse. One of them shot Bradford’s horse that belonged to Franklin Bayl, who was a moulder of irons and wickets for the canal. The posse took cover in some bushes and fired back with their Henry rifles, but they didn’t get their man.

In his later years, Nelson lived with his daughter, Sara Louise, and her third husband, Albert S. Thompson. Their home was near Cat Creek in the west addition of Annapolis.

Nelson Adolph McClure died on January 26, 1908, at the ripe old age of 94 years, 6 months and 12 days. He lived an exceptional life. He was laid to rest in Linebarger Cemetery, Parke county, Indiana.

Photo by Charles Davis



NELSON MCCLURE
BORN JULY 14, 1813
DIED JAN. 26, 1909
AGED 94YS. 6MS. 12DS.



Above: Sarah Louise (McClure) Thompson, daughter of Nelson A. McClure, Albert S. Thompson and grandson Maxwell Stout. Below: Fred Thompson, grandson of Nelson A. McClure, with wife Anna and children Owen, Camilla and Darrell around 1906.

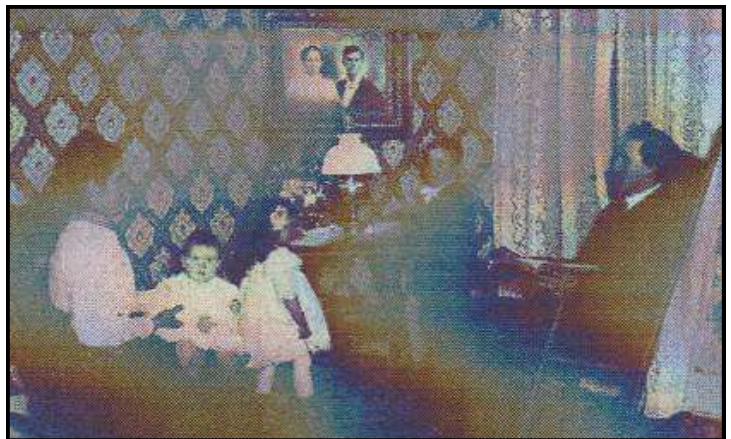

Sources:

Davis, Charles, *Parke County: The Civil War During the Canal Era*, 2006 in Rockville library

Deed records:

From Wm. Hunt

M. E. Church 11/208, 9-10-1849

Sons of Temperance Div. No. 148 Lots 5-6 Block 1

Recorders Office Rockville court house

Mary Jane Davis - computer research

Parke County Cemetery Records

Rockville Republican

Atcheson, R. G. Obituary of Nelson A. McClure, 2-5-1908

Obituary of Sarah Louise Thompson, 2-23-1939

Thompson, Fred, *History of Annapolis*, 1962 in Rockville library

THE HOOSIER PACKET - JULY 2015

NELSON ADOPH McCLURE'S FAMILY

<u>Name</u>	<u>Birth</u>	<u>Place</u>	<u>Death</u>	<u>Cemetery</u>	<u>Place</u>	<u>Marriage</u>	<u>Place</u>
McClure, Richard Renshaw	7/15/1760		1832	Chapman	Lawrence KY	6/27/1789	Botetourt VA
m. Crawford, Mary F. "Molly"	1762	VA	9/??/1814		Botetourt VA	6/27/1789	Botetourt VA
1 McClure, William	10/12/1789	VA	11/03/1861	McClure	KY		
2 McClure, Elizabeth	3/31/1791	VA	1792/1877		Lincoln Co W VA		
3 McClure, Cassandra	2/10/1793	VA	1824		Botetourt VA		
4 McClure, Mordecai	2/15/1795	VA	11/07/1880	Wesley Chap	Scotland IL	8/25/1823	Botetourt VA
m. Vickers, Mary Ann Riley	1/04/1805	VA	8/28/1852	Wesley Chap	Paris IL	8/25/1823	Botetourt VA
A McClure, Elizabeth Jane	9/16/1823	VA	1/16/1902	Bloomingdale	Parke Co IN	8/23/1843	
m. Welch, John W	10/11/1821	OH	12/18/1871	Bloomingdale	Parke Co IN	8/23/1843	
B McClure, John Alexander	1826		1848	Ingram	Scotland IL		
C McClure, Sara Ellen	1829		1875	Coffin	Annapolis IN	4/15/1852	Edgar Co IL
m. Wheeler, Daniel Erastus	4/??/1827		4/05/1912	Coffin	Annapolis IN	4/15/1852	Edgar Co IL
1 Wheeler, Leonard	5/26/1853		8/13/1890	Thomas	Vermillion Co IN		
2 Wheeler, Horace	5/26/1855		4/13/1927		Dana IN		
3 Wheeler, Emma	5/13/1859		8/12/1949		Jackson MS		
4 Wheeler, Elmer	8/29/1862		7/14/1946	Roselawn	Terre Haute IN		
5 Wheeler, Elvin	8/29/1862		1935	Ward 7	Atlanta GA		
6 Wheeler, Clarence	1867		? 1869	Coffin	Annapolis IN		
7 Wheeler, Albert	1870						
D McClure, Alfred Allen	1834		3/08/1915		Terre Haute IN	12/18/1852	Parke Co IN
E McClure, Mary Ann	5/10/1834		5/13/1904	Bloomingdale	Parke Co IN	12/18/1852	Parke Co IN
m. Woody, George C.	10/31/1831		9/14/1909	Bloomingdale	Parke Co IN	7/26/1877	Parke Co IN
1 Woody, Pyrena Augusta	1853		3/16/1940	Rosedale	Parke Co IN	7/26/1877	Parke Co IN
m. Goodin, Kane	4/01/1847		1/20/1918	Forest Lawn	Detroit MI	7/26/1877	Parke Co IN
a Goodin, Nellie Grace	1879	Parke Co IN					
b Goodin, Laura May "Lottie"	6/??/1880	Parke Co IN	5/??/1975	Rosedale	Parke Co IN		
c Goodin, Byron Chester	11/26/1885	Parke Co IN					
d Goodin, Harry H.	1890	Parke Co IN					
e Goodin, Harold N.	1892	Parke Co IN					
2 Woody, John	1/??/1856		2/22/1856	Bloomingdale	Parke Co IN	3/01/1894	
3 Woody, Charles N	9/24/1862		12/15/1940	Bloomingdale	Parke Co IN	3/01/1894	
m. Allen, Cordelia Grace	12/??/1870		10/23/1902	Bloomingdale	Parke Co IN		
a Woody, George					(of Washington IL)		
b Woody, Charles					(of Parke Co IN)		
4 Woody, Walter	1860		5/04/1919	Bloomingdale	Parke Co IN		

THE HOOSIER PACKET - JULY 2015

<u>Name</u>	<u>Birth</u>	<u>Place</u>	<u>Death</u>	<u>Cemetery</u>	<u>Place</u>	<u>Marriage</u>	<u>Place</u>
F McClure, Martha Francis	1835		1889	Coffin	Annapolis IN	5/19/1857	Parke Co IN
m. Carty, Uriah	3/04/1835	Rileyville OH	8/15/1894	Coffin	Annapolis IN	5/19/1857	Parke Co IN
1 Carty, Homer	1858		4/24/1852	Coffin	Annapolis IN		
2 Carty, Albert "Allie"	5/??/1860		5/??/1890	Coffin	Annapolis IN		
3 Carty, Arthelia B	1860		1890	Coffin	Annapolis IN		
4 Carty, Laura Bell	1862		8/??/1907	Silver Island	Fountain Co IN	6/11/1899	Parke Co IN
m. Shirk, David	10/09/1861		4/24/1925	Silver Island	Fountain Co IN	6/11/1899	Parke Co IN
5 Carty, Lucia	5/08/1864		2/10/1887	Coffin	Annapolis IN	2/21/1883	Parke Co IN
m. Byers, Franz Siggle	1862	Devil's Den Mills	6/04/1941	Bloomingtondale	Parke Co IN	2/21/1883	Parke Co IN
6 Carty, Minnie	1/02/1868		8/08/1890	Coffin	Annapolis IN		
m. Coffin, John M	8/23/1865		10/02/1941	Bloomingtondale	Parke Co IN		
7 Carty, Walter	5/06/1873		9/11/1893	Coffin	Annapolis IN		
G McClure, Joel Nelson	3/23/1839		12/11/1907	Chapel	Scotland IL		
m. ?, Almyra V	12/24/1858		9/30/1936	Chapel	Scotland IL		
H McClure, Benjamin Franklin	1841		1842	Coffin	Scotland IL		
I McClure, Nancy Isabell	4/23/1843		4/14/1850	Chapel	Scotland IL		
5 McClure, Eleanor	3/29/1797		after 1880	Peach Orchard	KY		
6 McClure, Elijah	4/07/1799		1880	Lincoln Co	Sod W VA		
7 McClure, Alazanah	9/13/1801		1802/1803		Lawrence Co KY		
8 McClure, John	3/16/1803		1803				
9 McClure, Strother	1/04/1806		1806				
10 McClure, Mary Reed	4/04/1808		1870				
11 McClure, Martha Isabell "Patsy"	9/19/1810		1811				
12 McClure, Nelson Adolph	7/14/1813	VA	1/26/1908	Linebarger	Parke Co IN	1/28/1838	Vermillion Co IN
m. Miller, Elizabeth Ann	5/20/1819		3/30/1859	Linebarger	Parke Co IN	1/28/1838	Vermillion Co IN
A McClure, James	1836						
B McClure, Mary Ellen	1839		3/31/1865			8/17/1859	Parke Co IN
m. Heidrick, James N	1834		2/10/1865			8/17/1859	Parke Co IN
1 Heidrick, Mary Elizabeth	4/23/1860						
C McClure, Mazarine J	11/16/1841		2/10/1862	Linebarger	(Killed Calhoun KY Co I 31st IN Vol)		
D McClure, Nelson J	1842						
E McClure, Sidney	1844		1860				
F McClure, Nancy Jane	3/30/1844		2/15/1905	Poplar Grove	Parke Co IN	2/15/1864	Parke Co IN
m. Hayes, James A*	1832		5/19/1948	Rockville	Parke Co IN	2/15/1864	Parke Co IN
1 Hayes, Mary Ione	1864		4/??/1893	Chapel	Vermillion Co IN	9/07/1884	Parke Co IN
m. Norris, Louis Christy	6/28/1859		7/09/1921	Chapel	Vermillion Co IN	9/07/1884	Parke Co IN
a Norris, James A				Rockville	Parke Co IN		

THE HOOSIER PACKET - JULY 2015

<u>Name</u>	<u>Birth</u>	<u>Place</u>	<u>Death</u>	<u>Cemetery</u>	<u>Place</u>	<u>Marriage</u>	<u>Place</u>
2 Hayes, Frank	1868		5/19/1948	Rockville	Parke Co IN	4/21/1891	Parke Co IN
m. Thomas, Barbara Ellen	1/17/1872		12/03/1941	Rockville	Parke Co IN	4/21/1891	Parke Co IN
a Infant							
*James A remarried after Nancy Jane's death							
m. Armstrong, Elizabeth	1/27/1905		1/?/?/1928	Rockville	Parke Co IN	8/21/1874	
3 Hayes, Louis	5/?/?/1878		9/06/1963	Memory Garden	Parke Co IN		
m. Torr, Della	5/?/?/1878		10/10/1963	Memory Garden	Rockville IN		
4 Hayes, Frank							
5 Hayes, Robert L							
6 Hayes, Lillian June							
m. Craig, W W	2/28/1905		11/23/1918	Rockville	Parke Co IN	5/15/1915	Parke Co IN
7 Hayes, Julia A	4/18/1887					5/15/1915	Parke Co IN
m. Gillian, Carl W	6/12/1884		11/10/1967	Memory Garden	Rockville IN		
G McClure, Sarah Louise	2/14/1847		3/22/1962	Memory Garden	Rockville IN		
m-1 Thompson, Morris Jr	12/18/1849		2/?/?/1939	Poplar Grove	Parke Co IN	11/07/1872	
1 Thompson, Ella	4/18/1873		12/10/1872	Miller	Lodi IN	11/07/1872	
m. Langley, David Marion	3/28/1875		9/15/1970	Covenant	Steuben Co IN	8/21/1896	Vermillion Co IN
a Langley, Paul Nelson	7/16/1897		3/?/?/1930	near Turkey Run	Parke Co IN	8/21/1896	Vermillion Co IN
m-2 Thompson, Anthony T	1847						
m-3 Thompson, Albert S	3/14/1837		1/22/1933	Poplar Grove	Parke Co IN	12/13/1881	Divc Dec 1891
2 Thompson, Fred*	1/03/1878		7/?/?/1969		Cleanwater FL	12/06/1892	
m. Long, Anna Jewel	6/?/?/1875		3/05/1962		Pineallas Co FL	10/22/1898	Parke Co IN
a Thompson, Owen	3/?/?/1900					10/22/1898	Parke Co IN
b Thompson, Camella	11/08/1902					(of Gar4y IN)	
m. Fisher, Alfred A	5/08/1900	Waveland IN	2/3/1929		Detroit MI	1920	
1 Fisher, Betty Lou	11/21/1921	Crawforesville IN	12/?/?/1955	Waveland IN	Indianapolis IN	1920	
m. Jennings, Joseph	4/26/1923		12/09/1993	Forest Lawn	Ann Arbor MI		
2 Fisher, Carolyn Ann	5/05/1925	Waveland IN	11/11/2004		Washtenaw Co MI		
c Thompson, Darrell Vance	2/01/1905		7/12/2011		Leawood KS		
d Thompson, Muriel E	5/25/1908		2/04/1999	Calumet Park	Lake Co IN		
H McClure, Charity Ann	6/19/1849		4/21/1977	Imperial Memor	Pueblo Co CO		
I McClure, Charles Wesley	7/?/?/1852		3/30/1859	Linebarger	Parke Co IN		
J McClure, John Renshaw	9/03/1855		9/03/1856	Linebarger	Parke Co IN		

* Fred's mother was apparently unmarried at the time he was born