

**JOHN NEWLIN CARTER  
THOMAS CARTER  
AND THEIR WABASH AND ERIE CANAL  
CONNECTIONS REVISITED**

By Charles Davis

John Newlin Carter was born March 17, 1819 near Hillsboro, North Carolina to John and Ruth Newlin Carter. John was the youngest of their seven children. His mother died in 1826 and was buried in Orange county, North Carolina.

When John was five years old, his father moved his family to Indiana, making the journey from North Carolina through Tennessee and Kentucky in a covered wagon. They first located in Orange county. His father married a second time on June 9, 1827, thus Hannah Holiday became John's new step-mother. After a few years they moved to Parke county, Indiana, arriving in the Bloomingdale settlement on the last day of November, 1830.

The Carter family spent the first winter in a cabin near Bloomingdale. John, with other children of the neigh-

borhood attended school in a log house, which was built in the woods just north of where the Friends church now stands. This was the typical pioneer school house having a puncheon floor, small windows and rude benches in lieu of desks. The room was warmed by two huge fireplaces. The course of study consisted of the three "R's," principally, but was thorough and practical as far as it extended.

In 1831 John's father entered land in Howard township, the west-half of the south-west quarter of section 34, which consisted of 80 acres, and the west-half of the south-west quarter of section 27, which also consisted of 80 acres. The latter is near the head of the ravine known as Turkey Run. It is there that the family lived for several years.

As a boy John attended the first quarterly meeting held by the Friends church at the old meeting house in the south part of the town near the Friends cemetery. Later, as a young man, he assisted at log rollings where great logs of oak, walnut and poplar were burned because at that time there was no market for them.

On February 23, 1832, a Friends society was instituted in the log cabin of John Newlin Carter in Washington

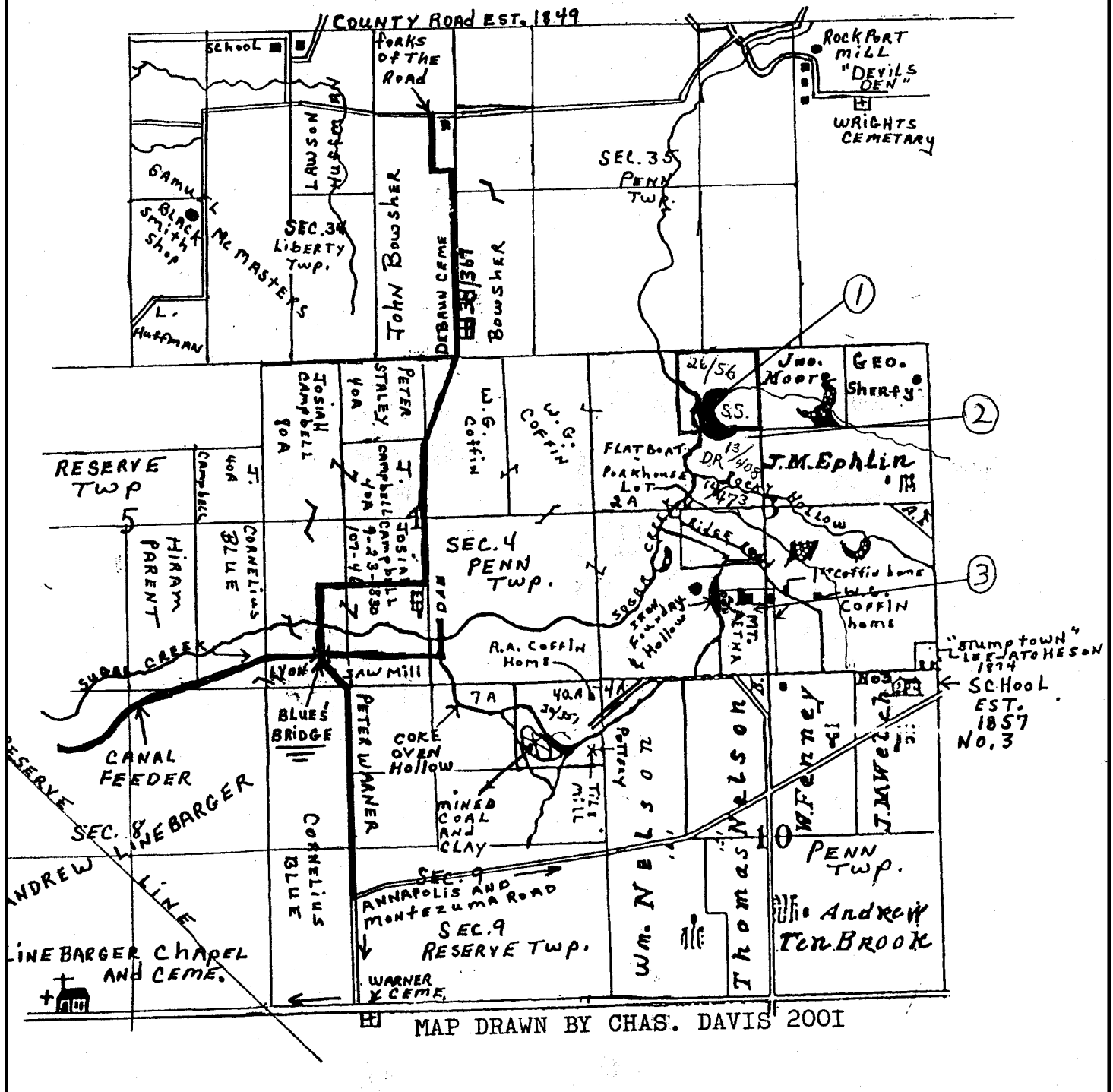

PARTIAL MAP OF PARKE COUNTY, INDIANA

1. John Bowsher sold to Thomas Carter 35 acres, NE¼ of NW¼ section 3 containing stone quarry of March 5, 1853. D.R. 26/56
2. William Dallas sold to Thomas Carter 40 acres, SE¼ of NW¼ section 3 January 28, 1851. D.R. 13/408
3. William B. Coffin sold to Thomas Carter 2.47 acres, 18.12 acres, surveyed from section 3, half mile stake on south side, December 5, 1851. D.R. 13/409 This land on the east side was first sold by W. G. Coffin to Thomas C. Coffin and contained 14.98 acres on June 8, 1836. D.R. 3/448 The land on the west side was sold by William Rubottom to Thomas C. Coffin containing 3.03 acres. D.R. 3/449 Inside of this land was Mt. Aetna Manufacturing Company owned by Rayl, Coffin, Huggins 1.40 acres. D.R. 8/167

## THE HOOSIER PACKET - SEPTEMBER 2015

township. His parents were involved with this and that year a meeting house was built of logs on the land of John Maris, the north-east quarter of the south-west quarter of section 5. This church was known as the Poplar Grove church. This was east of the Isaiah Mote mill on Roaring creek.

The Isaiah Mote mill was located north of the now extinct town of Cincinnati in the late 1830s and 40s. The deed for the mill is Deed Record 4/59 1837. Nelson Adolph McClure, a sawyer on the canal feeder dam project, recalled riding on horse back behind John Newlin Carter in their youth going to this mill from Annapolis on the old Indian trail.

In 1844 when the construction of the Wabash and Erie Canal began in Parke county, John's brother, Thomas Newlin, was one of the contractors.

In 1849 John's father died and was buried in the Poplar Grove cemetery. John continued to farm while living with his mother and 3 siblings. 1850 census His brother Thomas bought 40 acres, the south-east quarter of the north-west quarter of section 3 in Penn township on January 28, 1851, from William Dallas. D.R. 13/308 This land contained a large sandstone deposit that laid on Sugar creek. Thomas and John quarried this stone and shipped it by canal boat to Terre Haute. Thomas bought the adjoining land north of it from John Bowsher on March 5, 1853, and thus owned the entire sandstone deposit. D.R. 26/56

Thomas also owned his own canal boat, "Thomas Carter," at the time he was living at Mt. Aetna near Foundry Hollow where William Gaston Coffin's Sugar Creek Iron Foundry was located. He registered the boat on April 8, 1852. Its commander was John W. Welch, a potter from Ohio who was part owner of the Annapolis pottery.

John Newlin Carter recalled "driving in wagons to Cincinnati, Ohio and Evansville, Indiana for merchandise; of hauling loads of stoneware from the potter shop near Coke Oven Hollow to Chicago; of two trips to New Orleans on flat boats loaded with farm produce; and two summers spent on the old Wabash and Erie Canal, freighting sandstone from the bluffs of Sugar Creek to Terre Haute." Carter, John Newlin. "A Pioneer," *Rockville Republican* April 11, 1906.

On October 8, 1854, John married Mary Rayl. They had six children. On August 22, 1855 he bought 40 acres from his step-mother for \$320 in section 34, Howard township.. D.R. 15/694

Thomas sold the home-place to Kinchan Morgan on April 17, 1857. D. R. 17/351, Trust Deed, section 27 (Turkey Run). This 80 acres lies from the entrance of Turkey Run to the suspension bridge on Sugar Creek. John Lusk bought this acreage on July 3, 1899 from Kinchen's heirs.

John and Thomas' step-mother moved one mile south onto the south-west quarter of section 34. There John continued to farm and applied his trade as a teamster.

Thomas sold the stone quarry to his son, William Oliver Carter, on December 27, 1858. D. R. 18/426 Next John sold his 75 acre farm located just above his step-mothers land to Thomas on March 29, 1862. D.R. 20/565 Sometime later Thomas moved to Garrett, Illinois to live with his son. He passed away there on January 14, 1895.

John lived in Bloomingdale in his later years. He died there on September 27, 1912. His grave was unmarked until I, Charles Davis, made and set a marker for him in 2004.



This new horse barn was built in Turkey Run State Park in 1929 where the old horse barn once stood. In this 1930s picture Ora Sample, the grandson of John Newlin Carter is shown. He operated the horse stable in the 1930s for the park. Later his grandson Orville Dean Sample operated it.

Photo courtesy O. Dean Sample

# THE HOOSIER PACKET - SEPTEMBER 2015

## THOMAS & JOHN NEWLIN. CARTER'S FAMILY

Compiled by Charles and Mary J. Davis

<u>Name</u>	<u>Birth</u>	<u>Place</u>	<u>Death</u>	<u>Cemetery</u>	<u>Place</u>	<u>Marriage</u>	<u>Place</u>
Carter, Nathaniel	3-23-1746	PA	5-15-1822		NC		
m. Edwards, Sara Jane	4-17-1747		5-05-1797		NC		
Carter, John	1-22-1772	PA	6-05-1849	Poplar Grove	IN		
m. Holiday, Hannah	7-17-1800		11-14-1877	Poplar Grove	IN	6-09-1827	Lick creek MN Me
<b>Carter, Thomas</b>	8-01-1805	NC	1-14-1895	Upper Lester	Garrett IL		
m. Pickard, Eurine	9-30-1804		1-02-1880	Upper Lester	Garrett IL	11-13-1848	Parke Co IN
<u>Carter, Ruth</u>	11-13-1828		6-10-1924	Upper Lester	Garrett IL	11-13-1848	Parke Co IN
m. Rayl, Robert Lindsey	4-05-1817		10-04-1878				
<u>Carter, William Oliver</u>	12-03-1830		12-24-1917				
m1 Swaim, Pricilla			1854			10-30-1853	Parke Co IN
Carter, William	10-07-1854		12-27-1916		Kanaua OK		
m2 Newlin, Eunice E.,	10-31-1831		11-09-1895	Poplar Grove	Parke Co IN	5-04-1856	Parke Co IN
Carter, Malinda Ann	1867		9-29-1872	Poplar Grove	Parke Co IN		
Carter, John V.	8-14-1859		3-22-1939	Poplar Grove	Parke Co IN	2-16-1882	Parke Co IN
m. Ward, Lizzie A.						2-16-1882	Parke Co IN
Carter, Byron F.							
Carter, Edwin McClellan "Clell":	7-10-1861		10-28-1935	Poplar Grove	Parke Co IN	7-20-1884	Parke Co IN
m. Rice, Mahala Ann	7-10-1867		7-30-1925	Poplar Grove	Parke Co IN	7-20-1884	Parke Co IN
Carter, Roy							
Carter, Parke							
Carter, Mrs. Gleethel Boyd							
Carter, Ida J.:	9-07-1863		12-11-1933	Poplar Grove	Parke Co IN	9-22-1887	Parke Co IN
m. Rice, James						9-22-1887	Parke Co IN
Rice, Vernon							
Rice, Marvin							
Rice, Nellie							
Carter, Emma C.							
m. Barker, Lewis J.	1863		9-??-1943		Kirksville MO	11-10-1885	Parke Co IN
Barker, Omar Lewis			7-??-1944		Gardner, ND	11-10-1855	Parke Co IN
Barker, Herbert							of Gardener ND
Barker, Russell Lewis							of Kirksville MO
Barker, Mac Lewis							of Crown Point IN
Barker, Eva Lewis Myers							of Lowell IN
							of Crown Point IN

# THE HOOSIER PACKET - SEPTEMBER 2015

<u>Name</u>	<u>Birth</u>	<u>Place</u>	<u>Death</u>	<u>Cemetery</u>	<u>Place</u>	<u>Marriage</u>	<u>Place</u>
Carter, Ella J.	9-24-1863		8-25-1944	Highland Lawn	Terre Haute IN	6-26-1887	Parke Co IN
m. Wells, David J.	1858		12-19-1938	Highland Lawn	Terre Haute IN	6-26-1887	Parke Co IN
Wells, Virgil							of Denver CO
Wells, Audrey							of Pueblo, CO
Wells, Carter							of Marshall IN
Carter, Ruth Ann	1869		8-07-1952	Poplar Grove	Parke Co IN	2-05-1882	Parke Co IN
m. Miller, Charles P.	1863		9-02-1927	Bethany	Marshall IN	2-05-1882	Parke Co IN
Carter, Milae	1872		12-06-1940	Poplar Grove	Parke Co IN		never teacher
Carter, Charles	4-13-1875		4-12-1926	Poplar Grove	Parke Co IN	6-14-1919	
m. Sullivan, Agnes Mary						6-14-1919	
Carter, James Wm "Buddy"							
<u>Carter, James A.</u>							
m. Teague, Mary Teresa	1836		10-?-?-1909	Bloomingtondale	IN	3-24-1859	Parke Co IN
Carter, Lucinda W.	10-05-1839		8-05-1909	Bloomingtondale	IN	3-24-1859	Parke Co IN
m. Anderson, Louis P.	1864		11-02-1934	Bloomingtondale	IN		
Anderson, Raymond	1864	Sweden	1-15-1929	Bloomingtondale	IN		of Michigan
Carter, William H.							
Carter, Edward B.	1869		6-16-1935	Bloomingtondale	IN		
m. Woods, Daisey	1871		7-?-?-1952	Bloomingtondale	IN	9-03-1903	Parke Co IN
Carter, Russell	1875		7-?-?-1950	Bloomingtondale	IN	9-03-1903	Parke Co IN
Carter, Rose M.							of Lawrence KS
m. McKey, Frankj E.	1866		11-04-1943	Bloomingtondale	IN	8-19-1891	Parke Co IN
McKey, Patience Wilson	1863		8-12-1915	Bloomingtondale	IN	8-19-1891	Parke Co IN
Carter, Alice A.	7-17-1860		9-26-1906	Bloomingtondale	IN	12-24-1894	Parke Co IN
m. Bacus, William Reed	1860		1946	Cashatt	Sugar Creek IN	12-24-1894	Parke Co IN
Bacus, Martha							
Bacus, Mildred							
Bacus, Mary							
Carter, Martha E.	6-?-?-1862		11-08-1873	Poplar Grove	Parke Co IN		
<b>Carter, John Newlin</b>	3-17-1819		9-27-1912	Bloomingtondale	IN		
m. Rayl, Mary	4-?-?-1835	NC	2-04-1910	Bloomingtondale	IN	10-08-1854	Parke Co IN
<u>Carter, Ruth Ellen</u>	11-14-1857	NC	5-03-1939				
<u>Carter, Sarah E.</u>	1863						
m. Sample, Jacob William	12-?-?-1851		12/25/1911			12-09-1875	Parke Co IN
Sample, Ora J.	2-21-1877		10-31-1956	Bonebrake	Veedersburg IN	8-21-1898	Fountain Co IN
m. Helms, Edna Mae	11-?-?-1878		1952			8-21-1898	Fountain Co IN
Sample, Conway H.	6-09-1900		1931				
m. Bento, Elizabeth							

**THE HOOSIER PACKET - SEPTEMBER 2015**

<u>Name</u>	<u>Birth</u>	<u>Death</u>	<u>Cemetery</u>	<u>Place</u>	<u>Marriage</u>	<u>Place</u>
Sample, Glenwood	5-11-1924	12-05-2003	Friends Creek	Argenta IL	1-11-1949	Lowell IN
m. Crowder, Catherine					1-11-1949	Lowell IN
Sample, Glenn						of Georgia
Sample, Alan						of Argenta il
Sample Jeffrey						of Lawton OK
Sample, Jerry						of Monticello IN
Sample, Orville Dean	2-11-1926	5-30-2012	Bonebrake	Veedersburg IN	9-15-1944	Veedersburg IN
m. Bunch, Velma Vernice					9-15-1944	Veedersburg IN
Sample, Larry Dean						of Terre Haute IN
Sample, Gary		deceased				
<u>Carter, Mary E</u>	1861					
<u>Carter, Thomas E.</u>	1864	3-13-1873	Bloomingtondale	IN		
<u>Carter, Martha "Jennie"</u>	1-??-1867	9-??-1930	Bloomingtondale	IN		never seamstress
<u>Carter, William Oliver</u>	4-??-1870	4-29-1929	Indiana Home	Newcastle IN		